

Flexpipe

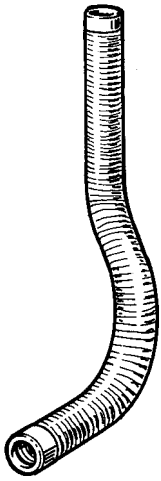

Part No.	Ø	L
7330	50	700
7308	50	1000
7331	76	700
7332	76	1000

Dustcontrol's Flexpipe is a new type of extraction arm for source extraction of welding fume, chemical vapors, wood dust, etc.

The flexpipe is a flexible hose that can be placed in practically any orientation desired.

Diameter of the Flexpipe is small and it can be used very close to the source without disturbing the work. Extraction is very effective.

The Flexpipe cannot be equipped with a hood or any other equipment at the free end.

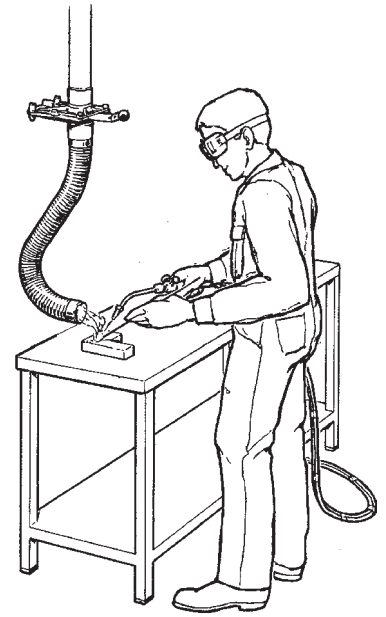
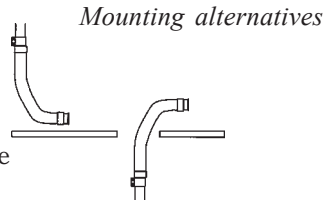

TECHNICAL DATA				
	7330	7308	7331	7332
Inner Diameter	Ø50	Ø50	Ø76	Ø76
Tubing System				
Connection	joint Ø50	joint Ø50	joint Ø76	joint Ø76
Length	700 mm	1 m	700 m	1 m
Air Flow	80-200 m ³ /h	80-200 m ³ /h	200-450 m ³ /h	200-450 m ³ /h

Pressure Loss Flexpipe

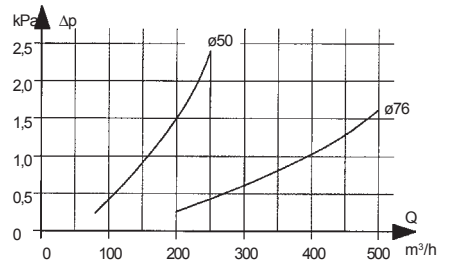

Swingarm for Flexpipe

Ø50 Part No. 5725

Ø76 Part No. 5726

The Flexpipe reach can be increased with swingarm installation. The swingarm length is easily adjusted by either cutting the horizontal tube or by replacing it with a longer tube from the standard tubing system, max. 3 m for Ø 50 and max. 4 m for Ø 76.

The swingarm may be equipped with suction hose but should not be loaded with anymore than the weight of the hose itself.

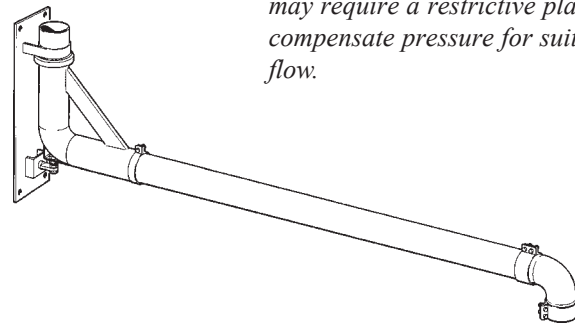

In high pressure systems, the flexpipe may require a restrictive plate to compensate pressure for suitable air flow.

Dimensions

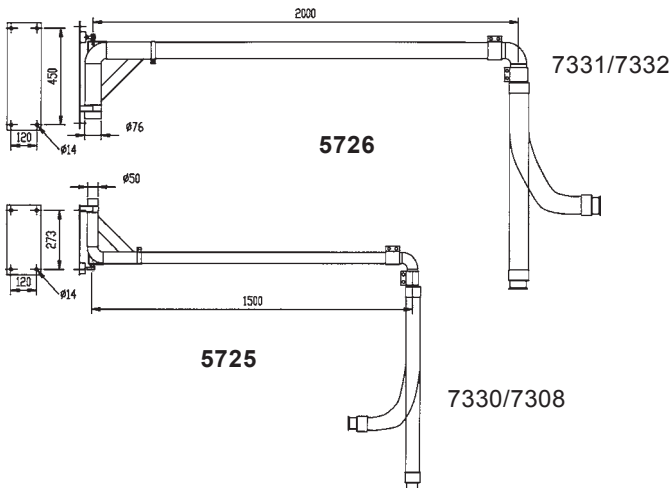

Pressure Loss Swingarm

